

L00 - Ground Floor Plan  
1:200



Typical Floor Plan\_First Floor - Sixth Floor  
1:200



L07 - Seventh Floor  
1:200

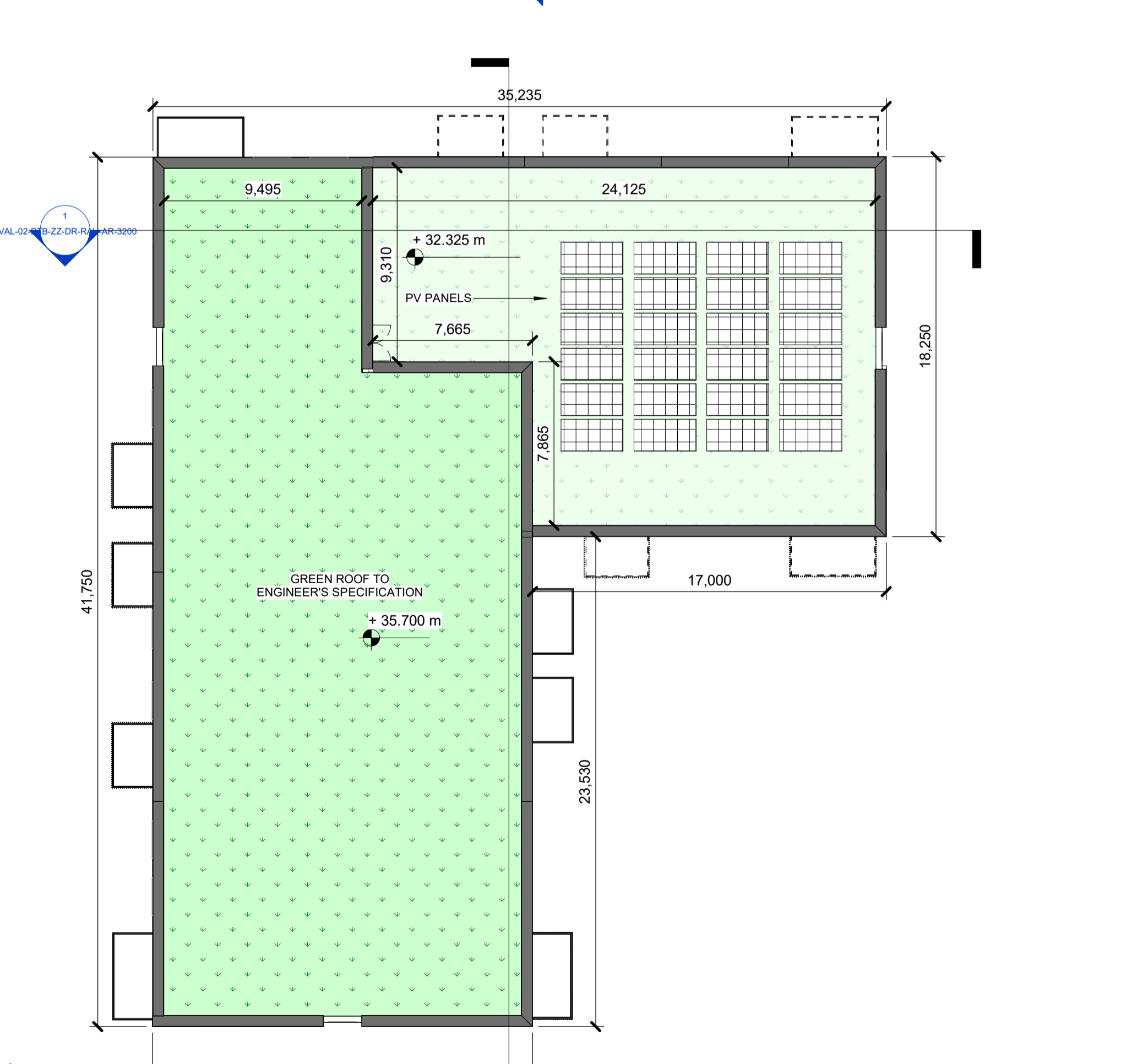

L08 - Roof  
1:200

**Notes:**  
- Do not scale from this drawing. Use figured dimensions in all cases.  
- Verify dimensions on site and report any discrepancies to the Architect immediately.  
- This drawing is to be read in conjunction with the Architect's Specification.  
- © This drawing is copyright and may only be reproduced with the Architect's permission.

**Drawing Notes:**

- UNIT TYPE LEGEND**
- 1B2P
  - 2B3P
  - 2B4P
  - Block B - Bike Store
  - Block B - Bins
  - Creche
- BIN STORE LEGEND**
- Mixed Non Recyclables
  - Dry Mixed Recyclables
  - Organic
  - Glass

**Site Key Plan**

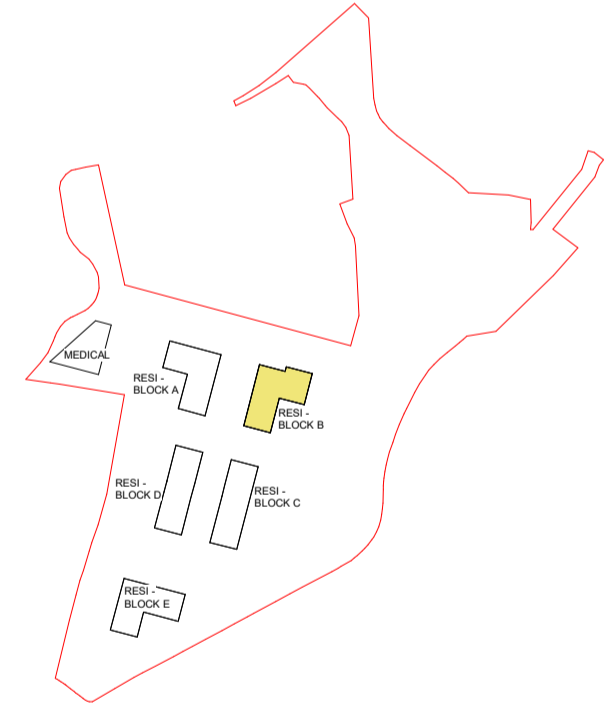

Rev.	Date	Drawn	Details of Issue / Revision
P5	19.05.2025	CR	LRD Application
P4	07.05.2025	LM	LRD Application
P3	30.04.2025	LM	LRD - Information
P2	20.10.2025	MM	Issued to S2/S3 Submission
P1	29.08.2025	MM	Issued to DT for Coordination

**Issues & Revisions**

46 O'Connell Street  
Limerick  
V94 8D88  
T: +353 (0) 6 127 6789  
W: www.reddyarchitecture.com  
E: info@reddyarchitecture.com

Client Details:  
**Kirkland Investments Ltd**

Project Details:  
**Parkway Valley - Mixed Use Development  
Singland, Dublin Road, Limerick**

Drawing Title:  
**Block B - Planning Drawings - Floor Plans**

Job No. <b>P24-308W</b>	Sheet Size: <b>A1_Landscape</b>	Scale @A1: <b>1:200</b>
Issue Date: <b>07/05/2026</b>	Drawn By: <b>MM</b>	Reviewed By: <b>MH</b>

Status: **S2** Purpose of Issue: **LRD Application**

Project - System - Spatial Zone - Level - Type - Originator - Role - Number <b>PVAL-02-BTB-XX-DR-RAU-AR-1200</b>	Revision <b>P05</b>
---	------------------------